



**BMX SUPERCROSS
WORLD CUP**

**MANCHESTER
GREAT BRITAIN**

Competition Guide

2016 UCI BMX Supercross World Cup

Manchester (Great Britain)

9 - 10 April





CONTENTS

1. WELCOME & INTRODUCTION	3
2. GENERAL INFORMATION	4
3. REGISTRATION	5
4. TEAM BIBS.....	7
5. RIDER ACCREDITATION.....	7
6. TEAM MANAGERS MEETING.....	7
7. EVENT SCHEDULE.....	8
8. TEAM AREAS.....	9
9. UCI OFFICIALS	9
10. TRAVEL & ACCOMMODATION	10
11. USEFUL INFORMATION.....	13
12. ABOUT MANCHESTER.....	18
APPENDIX 1 – VENUE LAYOUT.....	19
APPENDIX 2 - TEAM AREA BOOKING FORM	20
APPENDIX 3 - ACCOMMODATION BOOKING FORM.....	21



1. WELCOME & INTRODUCTION

On behalf of British Cycling, UK Sport and Manchester City Council I am delighted to invite you back to Manchester for the second round of the 2016 UCI BMX Supercross World Cup at the National Cycling Centre.

We are delighted that the Manchester round was awarded UCI BMX Supercross World Cup Event of the Year in 2015 and we are looking forward to welcoming you all back to the home of British Cycling for the fourth time in 2016.

Since the 2015 event, the track has undergone further developments, with changes to the first jump, third straight and final straight set to make for even more spectacular racing, which we hope will be enjoyed by riders and spectators alike.

Manchester's BMX track continues to provide Great Britain's athletes with a world-class training and competition facility and is hugely important for BMX in this country. Providing people from Greater Manchester and beyond with an accessible facility, the centre contributes significantly to the development of BMX from grass roots level upwards. We hope that the chance to see the world's best BMX athletes competing here will continue to inspire people to take part in the sport.

This competition guide should provide you with all the information you need to enter the UCI BMX Supercross World Cup and plan your journey to the event in Manchester. Should you require further information or have any questions please contact the organising team on bmxsuperx@britishcycling.org.uk.

Thank you for being part of what we anticipate will be a fantastic event. We look forward to welcoming you to Manchester.

Jonny Clay
Event Director
British Cycling

Join, follow and share the 2016 UCI BMX Supercross World Cup – Manchester

- Facebook: <https://www.facebook.com/BMXSuperX>
- Twitter [@BMXSuperX](https://twitter.com/BMXSuperX)
- Official website is www.bmxsuperx.com

2. GENERAL INFORMATION

The UCI BMX Supercross - Manchester will take place at the National Cycling Centre in Manchester. The facility is a fantastic purpose built indoor BMX track and sits alongside a new mountain bike trail and Manchester's famous velodrome as the home of British Cycling.

The venue is situated in the Sport City complex adjacent to the junction of A6010 Alan Turing Way and A662 Ashton New Road. Please note that ALL road direction signs are for the National Cycling Centre.

National Cycling Centre
Stuart Street
Manchester
M11 4DQ
England

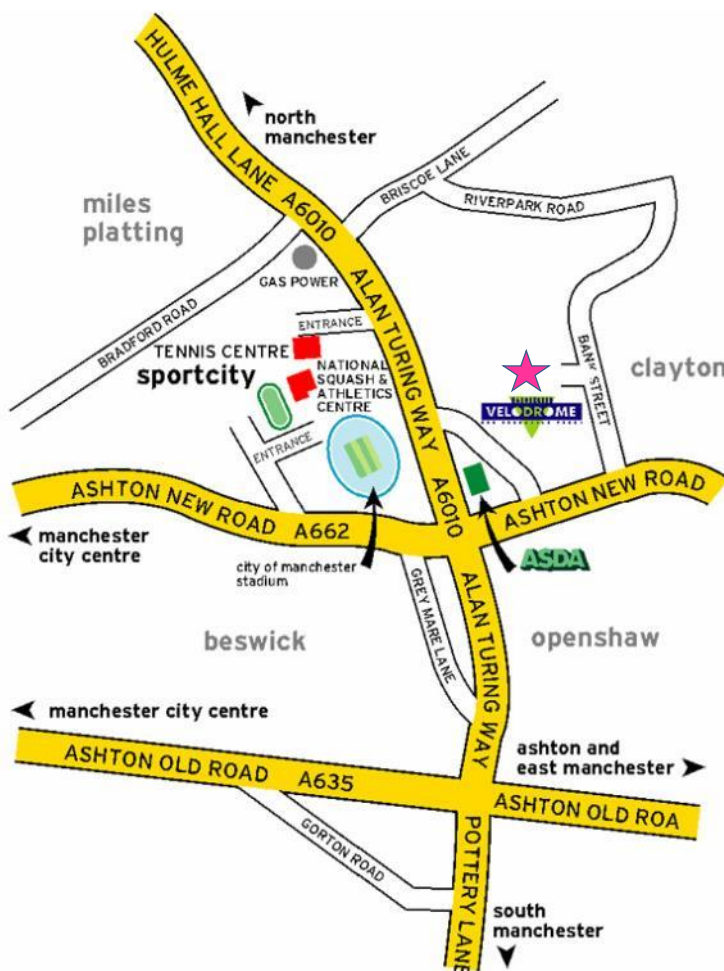



3. REGISTRATION

You can enter through the UCI website clicking as follows:

- **Web services** (on the homepage on the right side, last link)
- **UCI World Cups**
- **“Riders registration”**

Access: personal login and password of each National Federation.

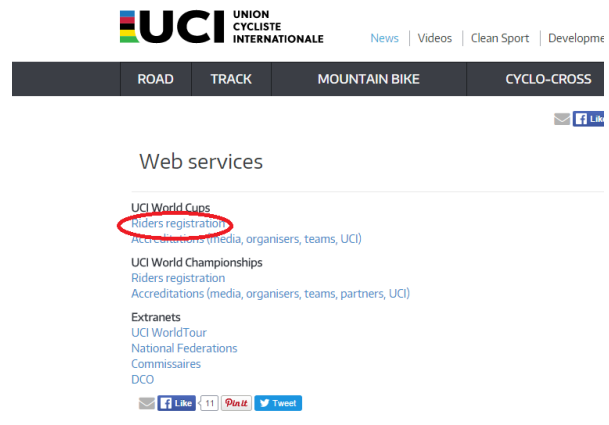
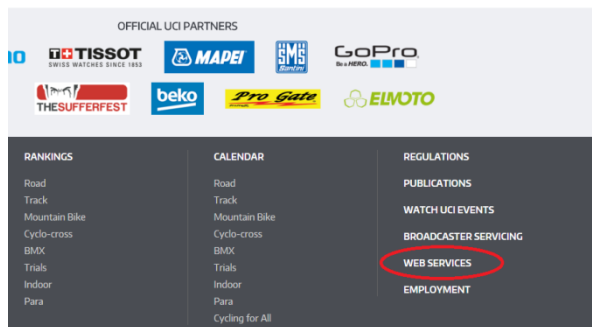

All riders must enter through their national federation; no individual entries will be accepted. Only Junior and Elite riders can participate at the UCI BMX Supercross World Cup. Registration deadlines are indicated in the General Race Parameters.

http://regonline.uci.ch/_layouts/login_Onlineservices.aspx?ReturnUrl=%2f

The name of the hotel where the riders will overnight must be given during the online registration.

The entry fee for the UCI BMX Supercross World Cup is **€150** for online registration.

There is a possibility to prepay by requesting an invoice or to pay in cash or by credit card on site. In case of prepayment, the receipt needs to be taken to the competition. To pre-pay the national federation must contact bmxsupperx@britishcycling.org.uk.

Please note pre payments must be made so that the entry fee is received into the organisers bank account before rider confirmation starts. If paying electronically Team Managers should bring proof of transfer to Rider confirmation to assist with any issues.

All riders/teams must attend the riders’ confirmation on the first practice day between 9.00 and 11.30 presenting their license and picking up their race numbers. Riders not being



confirmed before the indicated deadline did not complete the registration procedure and will not be able to compete at the event.

Riders that were registered through the online system but that are unable to participate will still need to pay their entry fee to the organizer.

Late Registration

Late registration is only possible through the National federation and until the riders' confirmation on site which is on the first training day between 9.00 and 11.30. The entry fee for a late registration is € 250 and should be paid immediately on site. Late entries are entries handled **after** the online registration deadline and **before** the riders' confirmation deadline. Once passed the riders' confirmation deadline no more late entries will be accepted.

Exchange rate: as per UCI financial obligations:

http://www.uci.ch/mm/Document/News/NewsGeneral/16/55/24/OF14_BMX_E_English.PDF

4. TEAM BIBS



Team Bibs will be provided for National teams (1 per nation) by the Secretary during the rider's confirmation.

This takes place on the first practice days between 9.00 and 11.30 at the registration room. Teams will be asked to pay €100 deposit.

The team bibs give access to allocated places explained by the PCP during the team managers meeting. This will include the Team Managers Area at the bottom of the ramp

The bibs need to be returned to the Secretary at the end of the competition. You get the deposit back when the bib is returned.

5. RIDER ACCREDITATION

All rainbow passes are delivered to the teams during the first event. If additional sporting passes are necessary the request needs to be send before the event to kevin.maccuish@uci.ch. For the request, please indicate the reason, the name and the contact details of the person for whom they are requested.

Rainbow Passes will be distributed during riders' confirmation in the registration room.

6. TEAM MANAGERS MEETING

The Team Managers meeting will take place at the National Cycling Centre in the Boardroom.

- Date: Thursday 7th April
- Meeting time: 19:00 – 19:30
- Location: National Cycling Centre – Boardroom
- All teams should have representation at this meeting.

7. EVENT SCHEDULE**Event Schedule****Thursday 7th April**

19.00 - 19.30 Team Manager Meeting

Friday 8th April

09.00 - 11.30 Rider confirmation & transponder distribution

13.00 - 14.25 Elite Men Practice - Group A**14.30 - 15.55 Elite Men Practice - Group B****16.00 - 17.25 Elite Women Practice - Group C****Saturday 9th April**

12.00 - 12.55 Elite Men Practice - Group A

13.00 - 13.55 Elite Men Practice - Group B

14.00 - 14.55 Elite Women Practice - Group C

Break & legacy practice

15.30 - 16.00 Autograph session

16:00 Doors Open

17.00 - 19.25 Elite Men Qualifications 16 motos (3 rounds)**Elite Women Qualifications 4 motos (3 rounds)**

19.30 - 19.45 Legacy racing

19.45 - 20.05 Sports Presentation

19.45 - 20:05 Warm-up TT Riders (Women 10m, then Men 10m)

20.10 - 20.30 Elite Women Time trials Superfinal**20.30 - 21.00 Elite Men Time trials Superfinal**

21.00 - 21.10 Awards ceremony

Sunday 10th April

13.00 - 13.45 Autograph session

14:00 Doors Open

14.00 - 14.25 Warm up Elite Women

14.30 - 14.55 Warm up Elite Men

15.00 - 15.05 Riders Introduction

15.05 - 16.45 Elite Men 1/8 Finals 1st round**Elite Women Quarterfinal 1st round****Elite Men 1/8 Finals 2nd round****Elite Women Quarterfinals 2nd round****Elite Men 1/8 3rd round****Elite Women Quarterfinals 3rd round***Break*17.20 - 17.40 **Elite Men Quarterfinals**17.45 - 17.50 **Elite Women Semifinals**17.50 - 17.55 **Elite Men Semifinal**18.00 - 18.10 **Elite Women Final**18.10 - 18.20 **Elite Men final**

18.20 - 18.30 Awards ceremony

Event schedule subject to changes

8. TEAM AREAS

In line with other events in the UCI BMX Supercross series team areas will be available to hire.

All **pre booked** team spaces will be indoors, these spaces are positioned underneath the 5m ramp and along the first straight.

Two options are available:

- Small (approx. 9m²)
- Large (approx. 20m²)

Each area includes premium parking, power and WIFI internet access. Spaces will be allocated on a first come first serve basis.

For small teams and individual riders an unreserved area with no power and Wi-Fi will be available.

Teams interested in booking a space may do so by completing the form in Appendix 3 and returning it to bmxsupex@britishcycling.org.uk.

Team Areas will be accessible from 09:00 Friday 8th April to Sunday 10th 20:00

Power will be available until 30 minutes after the end of competition each day.

Parking on site will be very busy you are not permitted to set up tents/gazebos/structures in the car park or take extra bays for storage of cycles.

The deadline to book is **Friday 1st April 2016** to allow arrangements to be made. Bookings are non-refundable and payment must be received before number plates are distributed.

Teams are not permitted to bring their own structures / tents / gazebos.

9. UCI OFFICIALS

<i>UCI Technical Delegate</i>	TBD
<i>President of the Commissaires' panel (PCP)</i>	Geordie Ma (CAN)
<i>Assistant PCP</i>	Euan Goodman (GBR)
<i>Secretary</i>	Christine Deconclois (FRA)
<i>3rd commissaire</i>	Tracey Vince (AUS)
<i>Doping Control Officer (DCO)</i>	Ole Olsen (DEN)

10. TRAVEL & ACCOMODATION INFORMATION

The official accommodation provider CSE have secured special accommodation rates at the Holiday Inn Manchester Central Park for teams and other relative personnel.

Team Hotel



Holiday Inn Manchester Central Park
888 Oldham Road
Newton Heath
Manchester
M40 2BS

Website: <http://www.ihg.com/holidayinn/hotels/us/en/manchester/mchcp/hoteldetail>

The Holiday Inn Manchester Central Park is conveniently located less than a mile from the track at the National Cycling Centre and just 2 miles from Manchester City Centre. The modern hotel offers comfortable bedrooms, a bar & restaurant offering a wide range of dining options and 24 hour room service. Guests can also benefit from complimentary onsite car parking & WI-FI access.

To book rooms please contact Mandy at CSE using the contact details below. You can also find the accommodation booking form in the Appendix below.

Please note requests are subject to availability.

CSE Contact Information

Mandy Bateman: E: Mandy@CORPORATE-SPORTING.COM

T: (+44) 0121 647 4096 F: (+44) 0121 647 4099

Official Hotel TBC

Travel

Transfers from the airport are not provided by the LOC, teams are required to make their own travel arrangements to and from the point of arrival

Manchester International Airport

Manchester International Airport is located approximately 11 miles from the National Cycling Centre. There are no direct public transport links from the airport to the national cycling centre, however regular direct trains to Manchester city centre are available.



The train from the airport to the city centre takes approximately 18 minutes with fares starting from £4.20 per person. Links are then available direct to the National Cycling Centre via the Metrolink.

There is also the option for a taxi directly to the National Cycling Centre which would cost approximately £25-£30 sterling for a standard car depending on traffic conditions.

Car or Van Hire

There are many options for Car or Van hire at Manchester International Airport, options are available on the Manchester Airport official website:

<https://www.cartrawler.com/manchesterairport/?clientID=429456>

Ferry Ports

For those driving to the event in order to transport cycling equipment please find below a list of the popular ports and the incoming ferry destinations;

Portsmouth: 240 miles to Manchester:

- Caen, France
- Cherbourg, France
- Jersey
- Guernsey
- Le Havre, France
- Ryde, Isle of Wight
- St Malo, France

Dover: 290 miles to Manchester:

- Calais, France

Liverpool: 35 miles to Manchester:

- Dublin, Northern Ireland
- Belfast, Republic of Ireland
- Isle of Man

Hull: 100 miles to Manchester:

- Rotterdam , Netherlands
- Zeebrugge, Belgium

Rail

Manchester city centre has two major train stations, Manchester Piccadilly and Manchester Victoria. Manchester Piccadilly provides a gateway to the south with direct connections to London Euston every 20 minutes with a journey time of 2 hours. Other major cities within an hour's train journey include; Leeds, Liverpool, Preston and Sheffield.

Metrolink

The Metrolink provides a tram directly from either Manchester Piccadilly or Victoria train



stations every 12 minutes to the National Cycling Centre site - the stop for the National Cycling Centre is 'Velopark'. This mode of transport is becoming increasingly popular for those travelling to the track from the train stations as it is simple and often quicker than using taxi's. Please visit the [Metrolink website \(http://www.metrolink.co.uk\)](http://www.metrolink.co.uk) for timetables and further information.

Please note: It is not permitted to take bikes on the Metrolink

11. USEFUL INFORMATION

Key Contacts

If you need further information about the UCI BMX Supercross World Cup, please contact the following persons:

Sport & Technical Aspects:	Kevin MacCuish BMX coordinator Kevin.MacCuish@uci.ch
Local Organising Committee:	Stuart Tomlinson British Cycling stuarttomlinson@britishcycling.org.uk
Team Liaison Contact:	Russ Gilston bmxsuperx@britishcycling.org.uk

Team Liaison

The organising committee has appointed a Team Liaison – Russ Gilston - to act as the main point of contact between participants and the organisers. They can be contacted on the email address above and will be available at the event to answer any enquiries.

Visa

Participants from some countries will need to obtain a visa in order to enter the UK. Should this be the case then we are able to provide you with a letter of invitation to the event in support of your visa application.

Should you need to receive such a letter, please email the following information to bmxsuperx@britishcycling.org.uk

- The full name, nationality, date of birth and passport number of each person that requires a visa.
- Whether the person seeking a visa is team staff or a rider participating in the event.

Training Opportunities

Indoor training

In the weeks leading up to competition, the BMX track can be booked for practice. This can be booked through the National Cycling Centre with more information on how to do this [here](#). In addition to track time, you will also be given the opportunity to book rooms, parking and catering.

Track Closed: 5 – 7th April

For any teams arriving early, there will be **no** training available on the track from Tuesday 5th to Thursday 7th April inclusive. This is due to the setup of the event.

Outdoor practice

There is the possibility to train on a local BMX facility whilst in Manchester – Platt Field BMX

Platt Fields BMX Track is home to the Manchester BMX Club -

<http://www.manchesterbmx.co.uk/> .

The track is located in Fallowfield, South Manchester approximately 4 miles from the National Cycling Centre.

The track is built to British national standard with a 3m hill has a range of technical features and is available for private hire to teams in the lead up to the UCI BMX Supercross World Cup.



To book time and find out more about charges and availability please email bmx@nationalcyclingcentre.com or telephone 0161 2232200.



Prize Money - UCI BMX Supercross World Cup – Manchester

Prize money for the top 8 men and women will be equal in Manchester. This is offered by British Cycling, UK Sport and Manchester City Council in support of positive steps towards gender equality in the sport. Also, the UCI has increased the overall prize money at the end of the series so that it is equal for women.

All prize money shall be available for collection from the accreditation centre at the end of competition, after the podium ceremony. Prize money will be paid in Euros.

	MEN ELITE		WOMEN ELITE	
	Per round	Overall	Manchester Only	Overall
1st	EUR 2'866	EUR 6'000	EUR 2'866	EUR 6'000
2nd	EUR 1'666	EUR 4'000	EUR 1'666	EUR 4'000
3rd	EUR 1'000	EUR 2'500	EUR 1'000	EUR 2'500
4th	EUR 800	EUR 1'500	EUR 800	EUR 1'500
5th	EUR 666	EUR 1'200	EUR 666	EUR 1'200
6th	EUR 600	EUR 1'000	EUR 600	EUR 1'000
7th	EUR 500	EUR 800	EUR 500	EUR 800
8th	EUR 400	EUR 600	EUR 400	EUR 600
9th		EUR 550		EUR 550
10th		EUR 500		EUR 500
11th		EUR 450		EUR 450
12th		EUR 400		EUR 400
13th		EUR 350		EUR 350
14th		EUR 300		EUR 300
15th		EUR 250		EUR 250
16th		EUR 200		EUR 200
Total	EUR 8'498	EUR 20'600	EUR 8'498	EUR 20'600

1st semi-final	
5th	EUR 150
6th	EUR 133
7th	EUR 100
8th	EUR 60
Total	EUR 443

Prize money to 8th

2nd semi-final	
5th	EUR 150
6th	EUR 133
7th	EUR 100
8th	EUR 60
Total	EUR 443



**BMX SUPERCROSS
WORLD CUP**

**MANCHESTER
GREAT BRITAIN**

Rider & Team Manager Seating

A reserved standing area will be available for team managers and riders to watch the racing. This will be accessed using an accreditation or wristband. There will also be a small area for Team Managers trackside on the start straight

Please note all general seating is being sold on a reserved basis, therefore there is no seating in the spectator stands for riders and team staff.

During competition accreditation will not grant access to the reserved spectator seating, a ticket will be required. Tickets can be purchased in advance of the event using the Ticketmaster link: www.ticketmaster.co.uk/britishcycling.

Performance Analysts

A row of seats has been reserved in the grandstand for performance analysts. Each analyst must collect a wristband from the Event Info to be able to access this area during ticketed sessions. The space is very limited and will be provided on a first come first served basis.

Please contact bmxsupex@britishcycling.org.uk prior to arriving in Manchester to reserve a position.

VIP

Watch world class BMX racing from an exclusive heated viewing area on the finish straight. The package includes a light buffet, access to a private complimentary bar, a souvenir programme and on-site parking.

Prices

Saturday 9th: £64.00

Sunday 10th: £69.00

Tickets can be purchased from the Ticketmaster website:

www.ticketmaster.co.uk/britishcycling

Media

All media persons planning to attend the event must be accredited in order to gain access to the venue. Media accreditation applications will open closer to the event. For more information and to apply please visit <https://www.britishcycling.org.uk/mediaaccreditation>

Passes will be available to collect from the Event Information Centre which will be open at the following times:

Date	Time
Friday 8 th April 2016	09.00-17:30
Saturday 9 th April 2016	11.00-21:00
Sunday 10 th April 2016	12:00-19:00

Only media with proven significant distribution will be granted media accreditation.

Water

The water from the tap in Great Britain is safe to drink unless stated.

Food

The National Cycling Centre Café is open for most of the event period, located on the ground floor at the front entrance to the centre. Please be aware that during competition breaks this will be very busy.

An athlete catering form will be available for you to pre-order meals when you arrive on site.

Medical Cover

A team of doctors and paramedics will be present throughout practice and racing. The team will be based on the track and also have use of a private medical room throughout the event.

The medical team will be available at the following times:

Official Practice Day

Friday 8th April - 12.00 to 17.30

Competition Days

Saturday 9th April - 11.30 to 21.00

Sunday 10th April - 13.30 to 18.30

The nominated hospitals are as follows.

Neurological

Salford Royal, Stott Lane, Salford, M6 8HD

0161 780 7373

Accident & Emergency

Manchester Royal Infirmary, Oxford Road, Manchester, M13 9WL

Tel: 0161 276 1234



An ambulance is on site to transfer very serious injuries to hospital, we ask that teams help ensure this resource is only utilised in serious circumstances by transferring athletes to hospital in their own vehicles wherever possible.

Economic Impact Study

Please note that at certain times during the event, athletes and team managers may be approached by researchers collecting data for an economic impact study. They will be seeking information regarding your travel, accommodation, length of stay in Manchester and whether you booked the venue for any pre event training camps. This study is of great importance to the event stakeholders and the findings from it may shape the extent to which they support a Supercross World Cup event in Manchester in the future. Therefore the organisers would be grateful if you could spend a short time answering their questions.



12. ABOUT MANCHESTER

Manchester is now one of the most successful and well known cities in Europe notably for its architecture, culture, music scene, media links, scientific and engineering output and sporting connections.

It is a city of firsts, driven by people who produce results and get things done. There was a phrase coined in Victorian times, 'What Manchester does today, the world does tomorrow', and with just cause. Manchester was the first city of the industrial revolution, sparking a new way of doing things that literally changed the world and are now embarking on sharing Graphene, its latest discovery, with the world.

Manchester is a globally recognised sports capital that has secured its place as an international destination for leisure, tourism and business and has rightfully gained a reputation as a place that makes things happen.

Manchester boasts world-class sporting facilities, an ever-growing sports development programme, a diverse major sports events portfolio and crucially, a network of partners whom we cooperate with on a number of levels

Manchester's events strategy outlines the commitment to maximising the benefits for its residents, businesses and visitors through the staging of world class sports events. Manchester also prides itself in being able to connect its events to its communities and partners not only regularly distributing thousands of event tickets to North West schools and colleges, sports clubs and charitable organisations, but linking numerous legacy activities with events.

Manchester offers a wide range of accommodation and a trusted public transport network system which is constantly being improved, with easy methods of connectivity to and from the city by air, rail and roads.

The digital connectivity of Manchester ranks amongst the best in the world with Media City UK at Salford—home to the BBC and Manchester Digital Hub boasting Europe's second largest creative, digital and media hub.

Manchester has an undisputable passion for sport, one that will ensure that the city's round of the 2016 UCI BMX Supercross World Cup will be the most exciting and entertaining BMX event possible.

For more information about Manchester and the shopping, nightlife and attractions the city has to offer, go to visitmanchester.com

APPENDIX 1 – VENUE LAYOUT

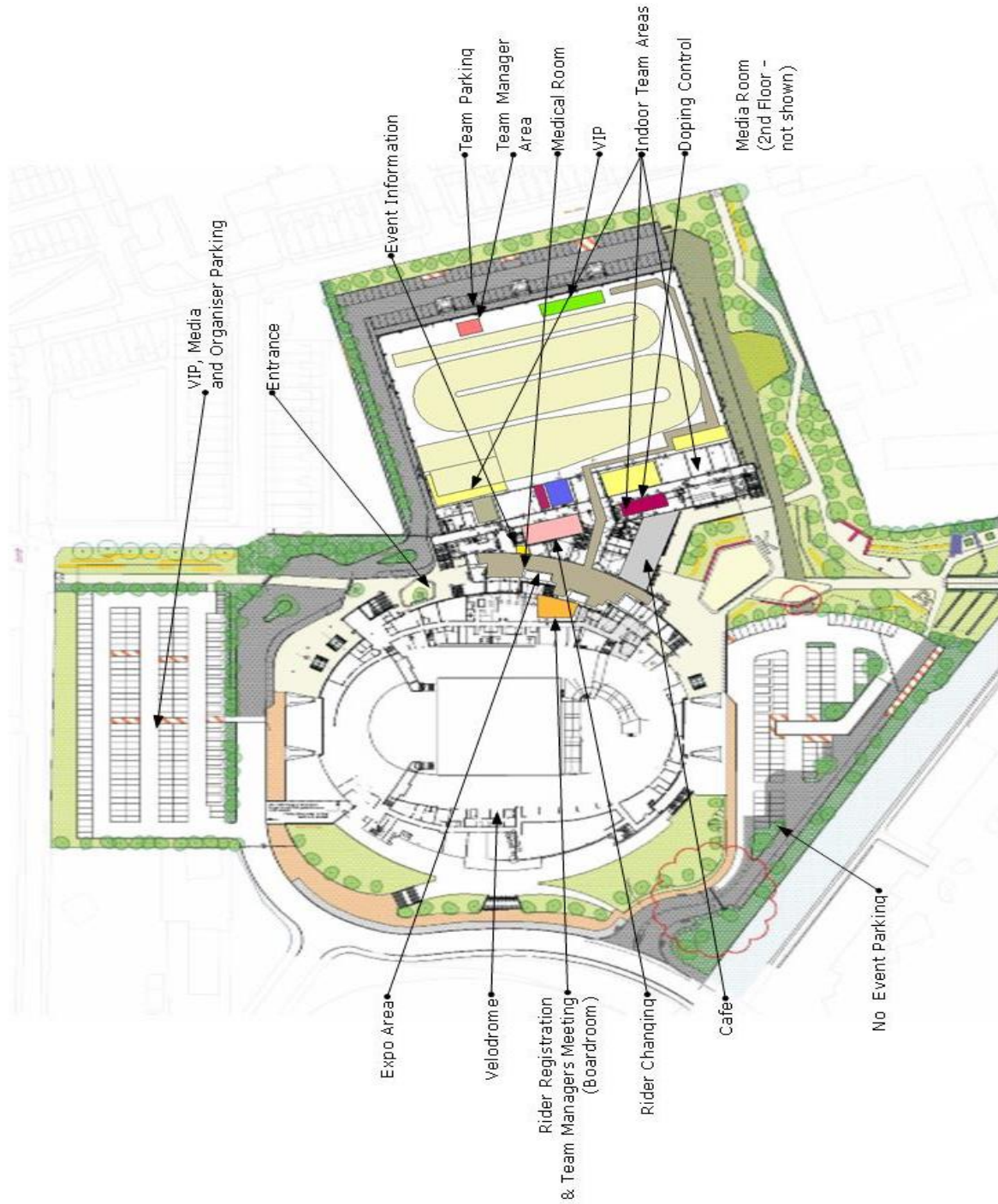



APPENDIX 2 - TEAM AREA BOOKING FORM

Personal Details

NATION/TEAM (For Invoice):	
APPROXIMATE TEAM SIZE (please circle)	0-5 6-10 11-15 16-20 21+
CONTACT NAME:	
TELEPHONE (Inc Int Code):	
EMAIL:	
ADDRESS:	

Rates

Size	Cost	Please Tick
Small space (approx. 9m ²) + premium parking for 1 vehicle	£250	
Large space (approx. 20m ²) + premium parking for 1 vehicle	£500	

All pre-booked small and large spaces are **indoors**, close to the track and include power and internet access.

For small teams and individual riders there is an unreserved area but this does not include power and Wi-Fi. Parking for vehicles is located further away from the track.

1. The area booked is the maximum space that can be used. Teams must check in with the team liaison coordinator Russ Gilston on arrival.
2. Vehicle access and parking passes will be allocated according to the area booked.
3. Teams will receive confirmation of receipt of booking form however; final confirmation of space will not be until full payment is received.
4. Positions will be allocated on a first come first serve basis.
5. **Teams are not permitted to bring their own structures.**



**BMX SUPERCROSS
WORLD CUP**

**MANCHESTER
GREAT BRITAIN**

APPENDIX 3- ACCOMMODATION BOOKING FORM

UCI BMX SUPERCROSS WORLD CUP – MANCHESTER
9th - 10th APRIL 2016

CSE has secured special accommodation rates at the Holiday Inn Manchester Central Park for attendees of the UCI BMX Supercross World Cup in Manchester on Saturday 9th & Sunday 10th April 2016.



The Holiday Inn Manchester Central Park is conveniently located less than 2kms from Manchester Velopark. The modern hotel offers comfortable bedrooms, a bar & restaurant offering a wide range of dining options. Guests can benefit from complimentary onsite car parking & WIFI access.

TWIN OR DOUBLE ROOM AT £44.50 per person sharing, per night
SINGLE ROOM AT £84.00 per night
Our rates are inclusive of buffet breakfast & VAT at 20%

To make your reservation, please complete the booking form below, circling your requirements where necessary...

TEAM NAME:

LEAD NAME:

ADDRESS:

TEL:

EMAIL:

Team size:

Arrival Date: THU 7th APRIL FRI 8th APRIL SAT 9th APRIL OTHER

Departure Date: SAT 9th APRIL SUN 10th APRIL MON 11th APRIL OTHER

Number of Nights: 1 2 3 4 OTHER

Room Type: SINGLE DOUBLE TWIN

(If you are booking more than one room please state the number of each room type required)

Please make your cheque payable to 'Corporate & Sporting Events'. Payments by credit card are subject to a 2.5% handling fee. Should you wish to pay by credit card please fill in your details below:

CARD TYPE: VISA CREDIT MASTERCARD VISA DEBIT MAESTRO

CARD NUMBER:

EXPIRY DATE:

START DATE or ISSUE NUMBER (MAESTRO ONLY):

3 DIGIT SECURITY NUMBER FROM REVERSE OF CARD:

CARDHOLDER NAME:

SIGNATURE:

.....

Your request is subject to availability at the time of booking so please return your form as soon as possible to:

Mandy Bateman

Corporate & Sporting Events, Alexander Stadium, Walsall Road, Birmingham, B42 2LR.

Tel: 0121 647 4096

Fax: 0121 647 4099

E: mandy@corporate-sporting.com